

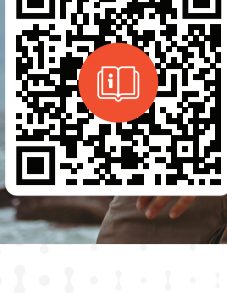

PARTYBOX
720



WHAT'S IN THE BOX



* Charge the speaker before first use.
** Power cord quantity and plug type vary by regions.

BLUETOOTH PAIRING

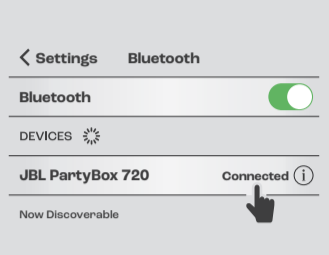

PLAY

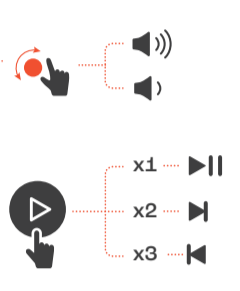

LIGHTSHOW



Apply lightshow presets and more with the JBL app.

APP

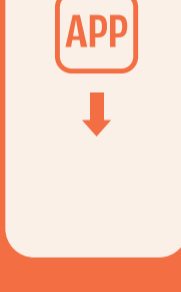

Download and install the JBL app to get more from the product.



MICROPHONE

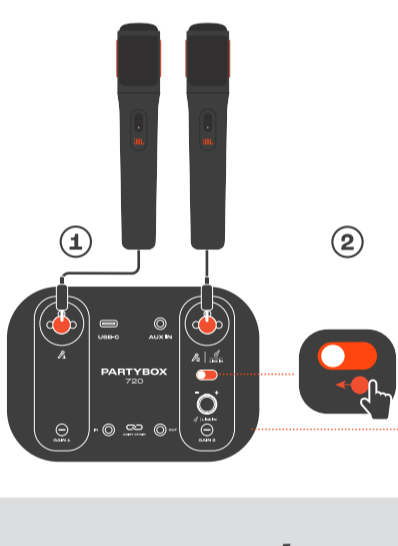

GUITAR/LINE IN

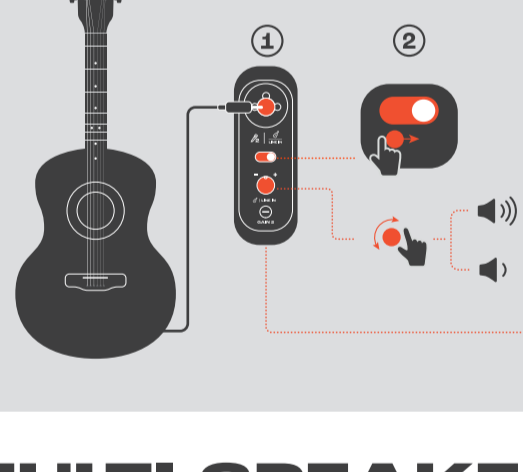

MULTI-SPEAKER CONNECTION



CHARGING

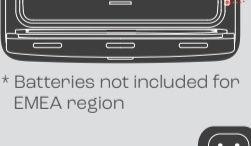

Low battery
Charging

* Batteries not included for EMEA region



SPLASH PROOF IPX4



BATTERY REPLACEMENT

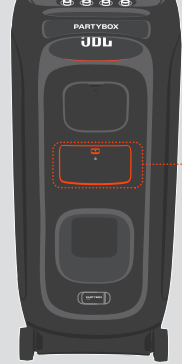

1 Remove the Old Battery



2 Insert the New Battery



Change the battery before first use.

