



WHAT'S IN THE BOX



* Charge the speaker before first use.
** Power cord quantity and plug type vary by regions.

BLUETOOTH PAIRING

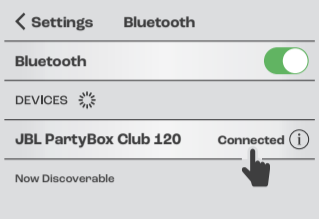
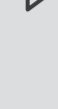

PLAY

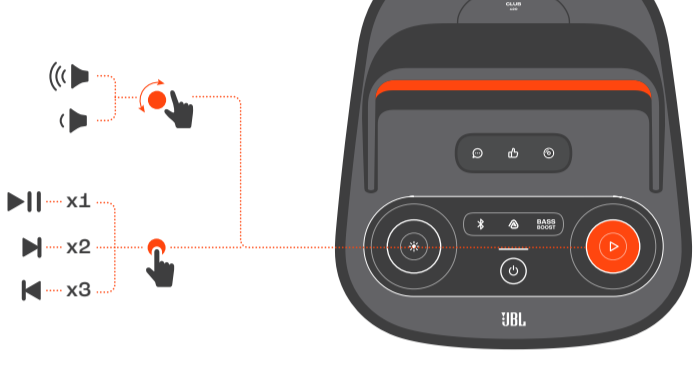

LIGHTSHOW



Apply lightshow presets and more with the JBL PARTYBOX app.

APP



Download and install the JBL PARTYBOX app to get more from the product.



JBL PARTYBOX



MICROPHONE



GUITAR

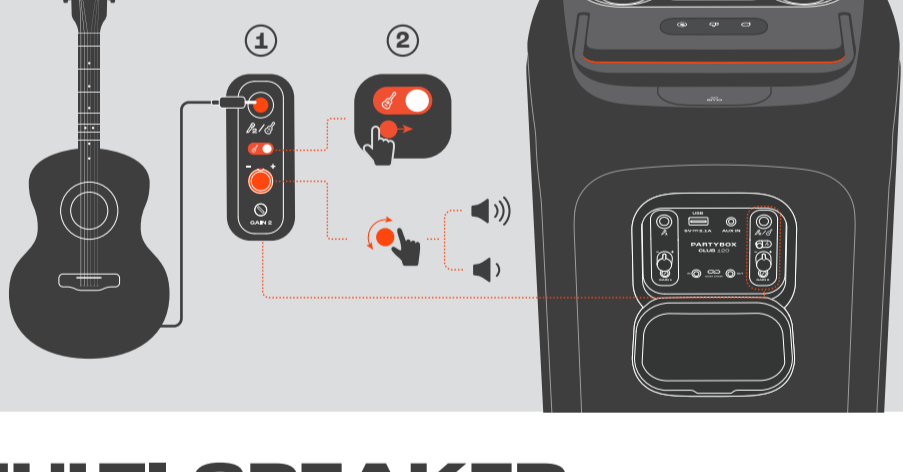

MULTI-SPEAKER CONNECTION



CHARGING



SPLASH PROOF IPX4



BATTERY REPLACEMENT

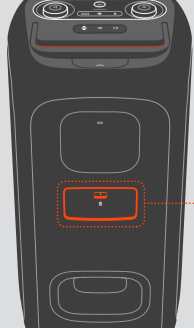

1 Remove the Old Battery



2 Insert the New Battery



Change the battery before first use.

